

## SPECIFICATIONS

- CONTRACTOR IS SOLELY RESPONSIBLE FOR JOBSITE SAFETY AND PROTECTION OF ALL PERSONNEL DURING CONSTRUCTION, INCLUDING EMPLOYEES, STAFF AND ALL OTHERS.
- CONTRACTOR TO PROTECT SURROUNDING AREAS FROM OVERSPRAY. CLEAN ALL AREAS TO MATCH EXISTING CONDITIONS.
- REMOVE AND RE-INSTALL CEILING TILES AS REQUIRED. REPLACE DAMAGED CEILING TILES.
- MV CONDUIT, PIPES AND OTHER INFRASTRUCTURE AWAY FROM SPRAY FOAM AREA TO THE EXTENT POSSIBLE WITHOUT CUTTING OR REMOVING CLAMPS OR TIES.
- SPRAY FOAM INSULATION
  - PROVIDE SUBMITTAL INCLUDING DATA SHEETS, MSDS, AND INSTALL INSTRUCTIONS.
  - DENSITY 2 LB/CU FT.
  - BASIS OF DESIGN: ACCELLA FOAMSULATE 220, LA FOLLA FOAM-LOK 2000-4G OR APPROVED COMPATIBLE EQUAL.
  - MAX GLOBAL WARMING POTENTIAL 1 OVER 20 YEARS.
  - R-VALUE 6.5 MINIMUM PER INCH OF THICKNESS PER ASTM C 518
  - DENSITY 2.0 LB/CU FT. PER ASTM D1622
  - CLOSED CELL CONTENT 96% PER ASTM D6226
  - VAPOR TRANSMISSION-PERMEANCE 15 PER 16 @ 1" THICKNESS PER ASTM E 96
  - FLAME SPREAD CLASS 1 LESS THAN 10 PER ASTM E 84
  - SMOKE DEVELOPED CLASS 1 LESS THAN 195 PER ASTM E 84
  - MUST COMPLY WITH ASTM E 119, NFPA 253, NFPA 285, NFPA 286.
- CONTRACTOR WILL COORDINATE AND PROVIDE ADDITIONAL AIR SEALING AROUND THE BEAM AS DISCOVERED BY A BLOWER DOOR TEST PRIOR TO INTUMESCENT PAINT. BLOWER DOOR TEST WILL BE PROVIDED UNDER SEPARATE CONTRACT BY 3RD PARTY.
- INTUMESCENT COATINGS
  - PROVIDE SUBMITTAL INCLUDING DATA SHEETS, MSDS, COMPATIBILITY ASSURANCE AND INSTALL INSTRUCTIONS.
  - PROVIDE INTUMESCENT IGNITION BARRIER COMPATIBLE WITH SPRAY FOAM.

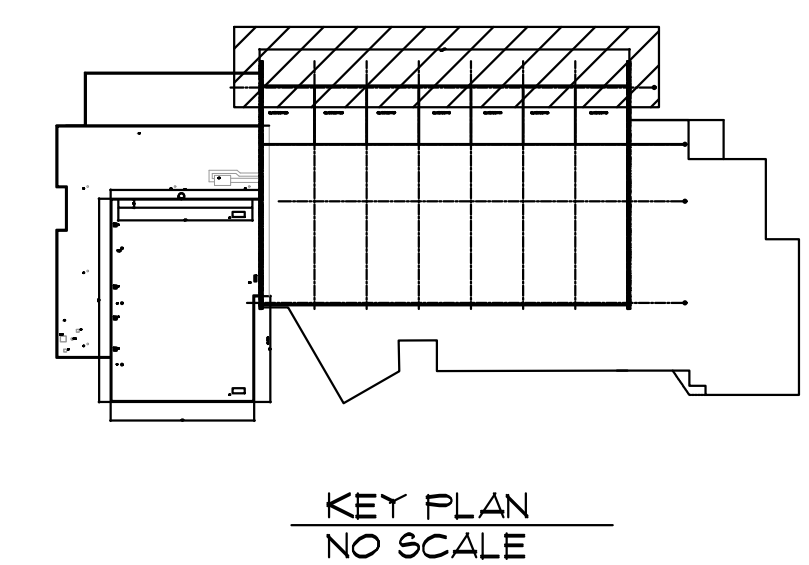
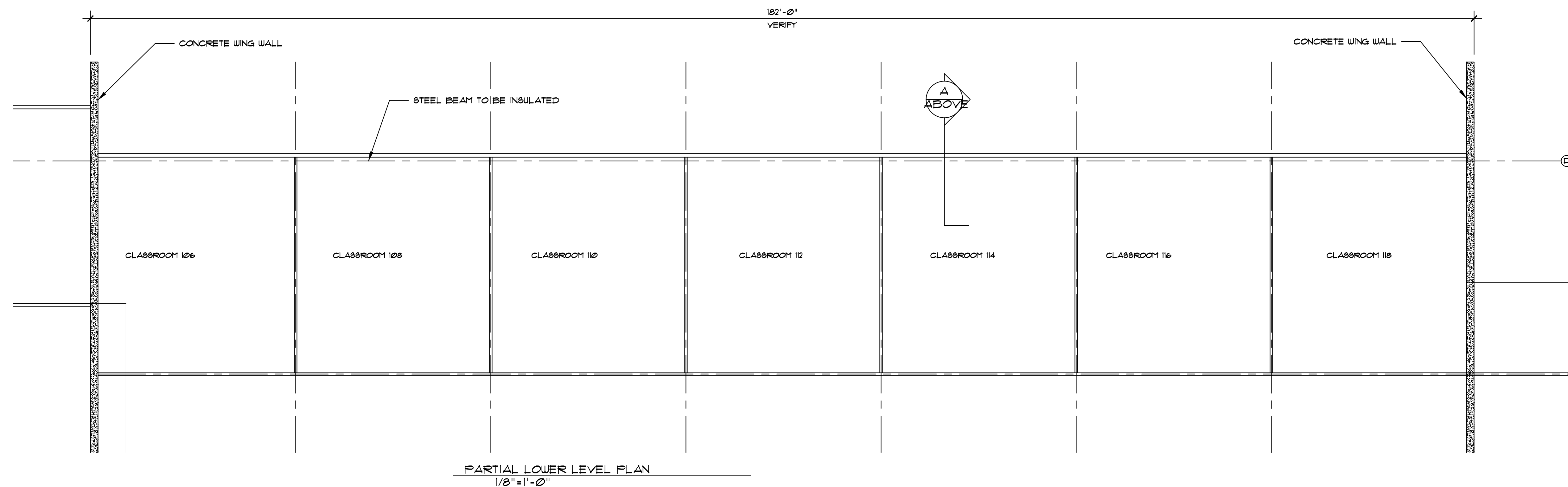

## HOLLIS UPPER ELEMENTARY SCHOOL BEAM INSULATION

HOLLIS MODERNIZATION AND REMEDIATION TASKS

Hollis Upper Elementary School  
Beam Insulation

12 DRURY LN, HOLLIS, NH

Windy Hill Associates

Architecture & Feng Shui

NEW BOSTON, NH  
603-487-5252

## PLANS

DRAWN BY: DAE  
DATE: APR 17, 20

CONSTRUCTION DOCUMENTS

© 2020  
WINDY HILL ASSOCIATES  
ALL RIGHTS RESERVED

A1-1